

MOZA Flight Base Clamp Instructions

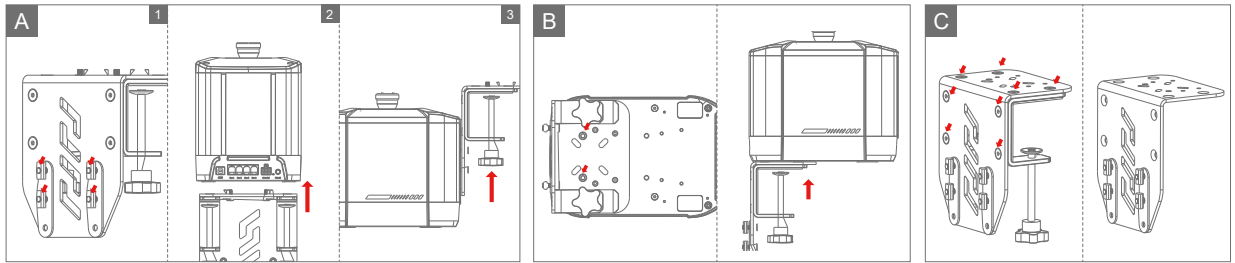

Figure A: Front mounted base to desk

1. Insert four M6x16 screws through the mounting plate and into the M6 channel nuts, tightening just enough to hold them in place.
2. Adjust the desk clamp direction so that the long end is facing upwards (as shown). Slide the rear channels of the base onto the channel nuts of the desk clamp and adjust to the desired position. Tighten the four M6x16 screws, ensuring that the end of the mounting plate does not obstruct the cable connections.
3. Place the assembly on your desk and tighten the star-shaped handles to secure the base to the desk or platform.

Figure B: Top Mounted Base to desk

1. Attach the base to the top mounting plate using either two M6x10 screws or four M4x10 screws (or both) as shown. Tighten securely.
2. Place the assembly on your desk and tighten the star-shaped handles to secure the base to the desk or platform.

Figure C: Mounting Directly to a Profile Rig or Plate

1. Remove the eight countersunk M6x9 screws to detach the C-clamp, leaving only the L-shaped plate (as shown).
2. Attach the base to the clamp using either method described in Figures A and B.
3. Attach the L-shaped plate to the aluminum profile or finished rig using the provided screws and T-nuts.

Note: When using the installation methods in Figure A or C, adjust the base height to prevent interference with the flight stick. If using the lowest screw hole on the L-shaped plate, it is recommended to pair it with the Z-axis module.